

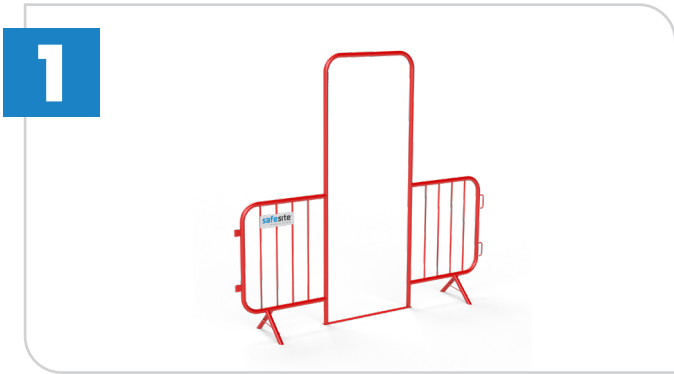

# PEDESTRIAN WALK THROUGH BARRIERS INSTALLATION GUIDE

These handy walk-through barriers are designed for temporary use to mark out pedestrian access and pathways. The barriers are easy to attach to other products and are typically used for outdoor events and construction sites.

<b>People to Install:</b> 	<b>Equipment / Accessories Needed:</b> No accessories or tools required.
------------------------------------------------------------------------------------------------------------------	-----------------------------------------------------------------------------



1 Ensure the ground is straight and level. If the barrier is placed on uneven ground this can cause connection issues.

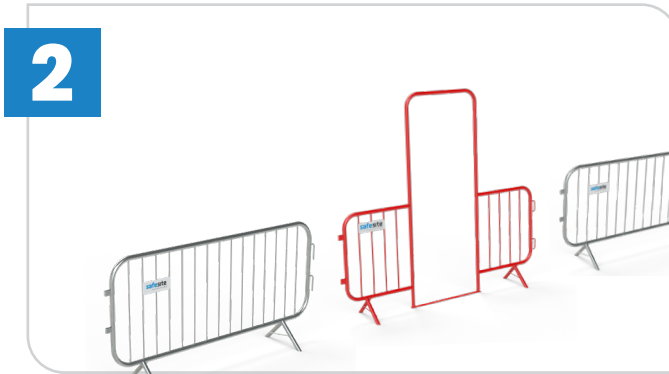

2 Position the barriers the same distance apart from one another.

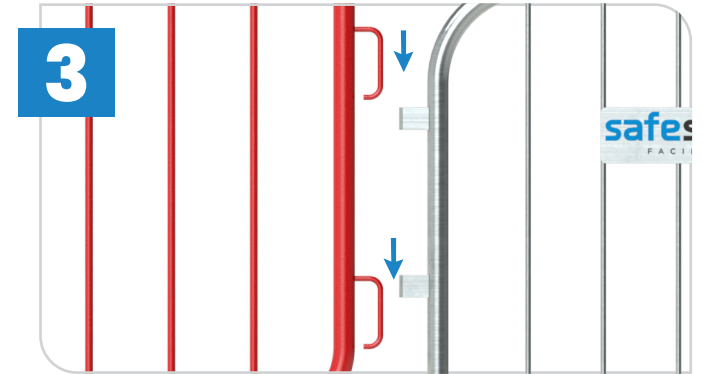

3 To interlock the barriers, lift the end of the pedestrian up, so that the hook can drop into the hoop on the end of the barrier.

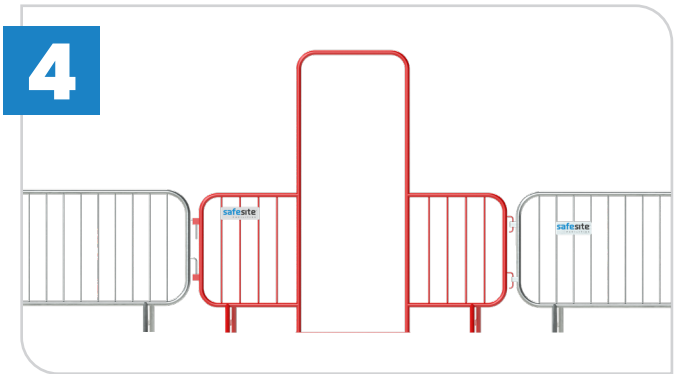

4 Check the position of the barrier and ensure that the join is stable. Ballast can be added for additional stability.

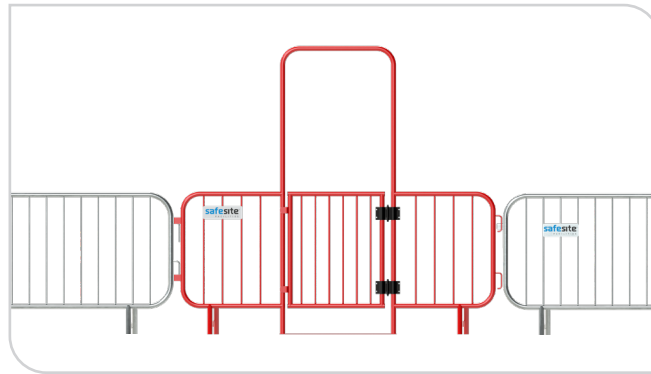

If there is a requirement to provide access, the Pedestrian Walk Through barrier can be provided. Gate walk through barrier option one features a plastic hinge.

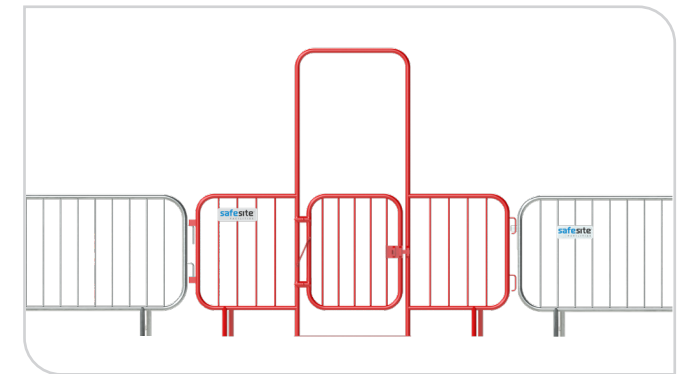

Gated walk through barrier option two is self closing and has a lockable latch.

